

## Application

The tri-section pulling plates, TMMS series, are especially designed for use in combination with three-armed pullers. The pulling plates TMMS series facilitate the easy and correct dismantling of bearings, especially SRB and CARB®, which are potentially suitable for re-use. They also facilitate the dismantling of components other than bearings, such as pulleys and/or flywheels, especially when it is not possible to grip on the outer diameter of the component.

## Description

The pulling plates, TMMS series, grip behind the inner ring of the bearing. This prevents the pulling forces from being transmitted through the outer ring and the rolling elements, minimising the risk of bearing damage. The pulling plates, TMMS series, are designed with a special protruding profile on the flat side, which tightly fits behind the inner ring, reducing the force required for dismantling. Additionally, inner ring pulling prevents bearing damage during dismantling, making it possible to re-use the bearing.

The three sections of the pulling plates evenly distribute the pulling forces, reducing the risk of bearing tilting, especially SRB and CARB®, during dismantling. The three sections also allow any three-armed puller to be used in combination with TMMS series. The TMMS series are not pullers but pulling plates; they are not supplied with beams or rods. They should be used in combination with three-armed pullers or beams and rods. The TMMS series consists of 5 different sizes of tri-section pulling plates suitable for shafts with maximum diameter ranging from 50 to 380 mm (2 to 15 in).

## Safety

- Dismounted bearings must be inspected to make sure they were not damaged during the dismantling operation or worn out before they are mounted again.
- For optimum safety during dismantling, we strongly recommend the use of puller protective blankets such the SKF TMMX series.



## Technical data

Designation		TMMS 50	TMMS 100	TMMS 160	TMMS 260	TMMS 380
Width of grip d min	mm	12	26	50	90	140
	in	0.5	1.0	2.0	3.6	5.5
d max	mm	50	100	160	260	380
	in	2.0	3.9	6.3	10.2	15.0
M	mm	-	M16 x2	M16 x2	M22 x2.5	M32 x2.5

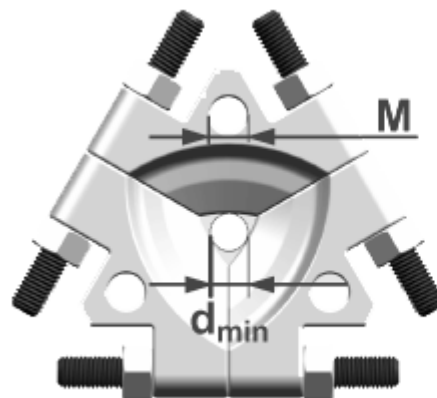

A	mm	20	36	45	70	81
	in	0.8	1.4	1.8	2.8	3.2
B	mm	-	34	52	81	97
	in	-	1.4	2.1	3.2	3.8
C	mm	32	60	82	110	138
	in	1.3	2.4	3.3	4.3	5.4

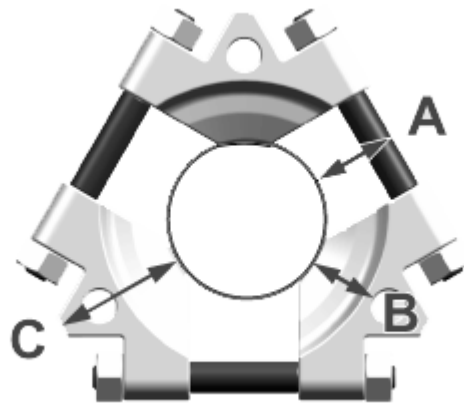

<b>Maximum withdrawal force (F max)</b>	kN	80	200	300	450	600
	ton imp.	8	20	30	45	60
	kg	0,5	2,6	5,9	18,4	50,3
	lb	1.1	5.7	13	41	110
<b>Weight</b>						

### Puller selection

The below table shows which SKF pullers can be used in combination with the new TMMS series.

Puller selection						
	TMMS 50	TMMS 100	TMMS 160	TMMS 260	TMMS 380	
TMMP 3x185	x	o	-	-	-	
TMMP 3x230	x	o	-	-	-	
TMMP 3x300	o	x	o	-	-	
TMMP 6	x	-	-	-	-	
TMMP 10	-	x	-	-	-	
TMMP 15	-	x	x	-	-	
TMHP 8	x	x	o	-	-	
TMMA 3	x	-	-	-	-	
TMMA 5	x	o	-	-	-	
TMMA 8	o	x	x	-	-	
TMHP 15	-	-	o	o	-	
TMHP 30	-	-	-	x	o	
TMHP 50	-	-	-	o	x	
		<b>x = recommended</b>		<b>o = possible</b>		<b>- = not possible</b>

