

Application

SKF reversible, two armed jaw pullers are designed for extracting mechanical components either by gripping on the outside of the component or through the bore. The maximum outside width of grip for the pullers ranges from 40 to 350 mm.

Description

Each TMMR F puller consists of a beam, two spreader arms and a mechanical spindle. The beam holds the arms in position and connects them to the spindle. When force is applied the arms automatically lock, prohibiting them from sliding apart. The beam is supplied with an hexagonal head which can be used to prevent the puller from rotating during the dismantling procedure. For safety reasons the puller is provided with a "safety neck". This special neck is the weakest point of the puller and will bend before any other damage will occur.

Note

Wear proper safety apparel to protect against personal injury.



Technical data

Designation	Width of grip (internal) (d)		Width of grip (external) (D)		Effective arm length (L)		Maximum torque (T)		Maximum withdrawal force (F)		Weight	
	mm	inch	mm	inch	mm	inch	Nm	lbf ft	kN	lbf	kg	lb
TMMR 40F	59-67	2.3-2.6	23-48	0.9-1.9	65	2.6	20	15	15	3.400	0,34	0.75
TMMR 60F	62-87	2.4-3.4	23-68	0.9-2.7	80	3.2	20	15	15	3.400	0,38	0.84
TMMR 80F	93-97	3.7-3.8	41-83	1.6-3.3	94	3.7	60	45	30	6.750	1,00	2.21
TMMR 120F	93-138	3.7-5.4	41-124	1.6-4.9	120	4.7	60	45	30	6.750	1,17	2.58
TMMR 160F	114-162	4.5-6.4	68-164	2.7-6.5	130	5.1	105	80	40	9.000	2,34	5.16
TMMR 200F	114-204	4.5-8.0	67-204	2.6-8.0	155	6.1	105	80	40	9.000	2,61	5.75
TMMR 250F	132-252	5.2-9.9	74-254	2.9-10	178	7.0	140	105	50	11.250	4,40	9.70
TMMR 350F	135-352	5.3-13.9	74-354	2.9-13.9	233	9.2	140	105	50	11.250	5,19	11.44
TMMR 8	Complete kit of 8 pullers on a counter rack											

Designation	Claw height (a)		Claw length (b)		Claw width (c)		Spindle hexagonal head (AF)	Beam hexagonal head (AF)
	mm	inch	mm	inch	mm	inch		
TMMR 40F	4	0.16	6	0.24	13	0.52	13	14
TMMR 60F	4	0.16	6	0.24	13	0.52	13	14
TMMR 80F	7	0.28	14	0.56	19	0.75	17	22
TMMR 120F	7	0.28	14	0.56	19	0.75	17	22
TMMR 160F	9	0.36	18	0.71	22	0.87	22	30
TMMR 200F	9	0.36	18	0.71	22	0.87	22	30
TMMR 250F	10	0.40	22	0.87	28	1.11	24	32
TMMR 350F	10	0.40	22	0.87	28	1.11	24	32

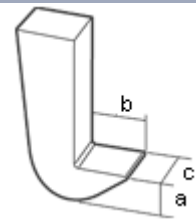

Replacement parts

Designation	Description
TMMR ...F-3	Spindle

