



Dismounting

# SKF Product Data Sheet

## Blind housing puller kit TMBP 20E

### Removes bearing without dismantling machinery

The SKF TMBP 20E is an adapter type puller for dismounting deep groove ball bearings in blind housings (i.e. when accessing the ball bearing is not possible through the outer ring or through the bore) with shaft dimensions between 30 mm and 160 mm (1.18 in and 6.3 in). The use of extension rods allows a long reach of up to 583 mm (23 in).

- With 6 sets of adaptors, a wide of range of deep groove ball bearings can be dismounted
- New ball adapters are more durable
- Spanner stop function on spindle for easy and safe handling
- Special nose piece helps in minimizing damage to shaft and improves puller stability
- Nosepiece with self-locking function



- Remove seal and open selected section of ball cage. Clean the swarf out.
- Insert appropriate bearing adapter and rotate it 90° to achieve a firm grip within the bearing raceway.
- Insert the second adapter into prepared area diametrically opposed.

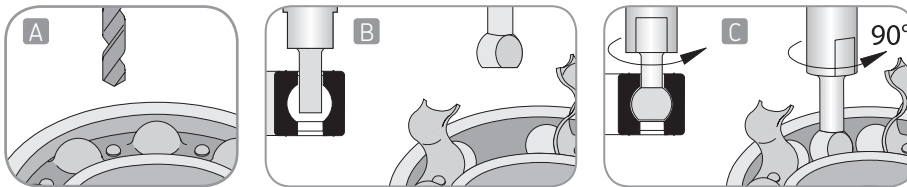

#### Technical data

<b>Designation</b>	<b>TMBP 20E</b>	<b>Kit contents</b>	Adaptors size A to F (2 pcs each) 2 x main rods (with nut support rings and nuts) 4 x extension rods Spindle Nose piece for spindle Beam IFU card Carrying case
<b>Arm length</b>	183 mm (7.2 in)	<b>Spare parts</b> TMBP 20E-1	Spindle with nose piece
<b>Extension piece length</b>	200 mm (7.9 in)		
<b>Maximum arm length (incl extension pieces)</b>	583 mm (23.0 in)	<b>Accessories</b> TMBA G11W LGEV 2/0.0035 TMMX 280	Gloves Spindle grease Puller protection blanket
<b>Maximum pulling force</b>	55 kN (6.2 ton US)		
<b>Maximum torque</b>	155 Nm (114 lbf ft)		
<b>Spindle head AF size</b>	22 mm		
<b>Dimensions of case</b>	395 x 300 x 105 mm (15,5 x 11,8 x 4,1 in)		
<b>Weight</b>	7,5 kg (16.5 lb)		

## Selection chart TMBP 20E

Bearing adapter	A	B	C	D	E	F
Spanner size for mounting	9 mm	11 mm	14 mm	15 mm	17 mm	19 mm
Ball adapter size	16 mm	19 mm	23,5 mm	26,5 mm	28 mm	30 mm
Bearing series						
60..	6021 6022 6024	6026 6028 6030	6032			
62..	6213 6214 6215 6216	6217 6218	6219 6220	6221	6222 6224 6226 6228 6230 6232	
63..	6309	6310 6311 6312	6313 6314 6321	6315 6316	6317 6318	6319 6320
64..	6406	6407 6408 6409	6410	6411 6412	6413	6414 6415 6416 6417 6418
160..		16026 16028 16030 16032				

## SKF Maintenance Products

© Copyright SKF 2006/01

[www.mapro.skf.com](http://www.mapro.skf.com)  
[www.skf.com/mount](http://www.skf.com/mount)

*The contents of this publication are the copyright of the publisher and may not be reproduced (even extracts) unless permission is granted. Every care has been taken to ensure the accuracy of the information contained in this publication but no liability can be accepted for any loss or damage whether direct, indirect or consequential arising out of use of the information contained herein.*

© SKF is a registered trademark of the SKF Group.

